



# UiLED TECHNOLOGY

Good People, Good Work.



We are committed to deliver high quality, cost-effective, energy saving LED products for the global market.

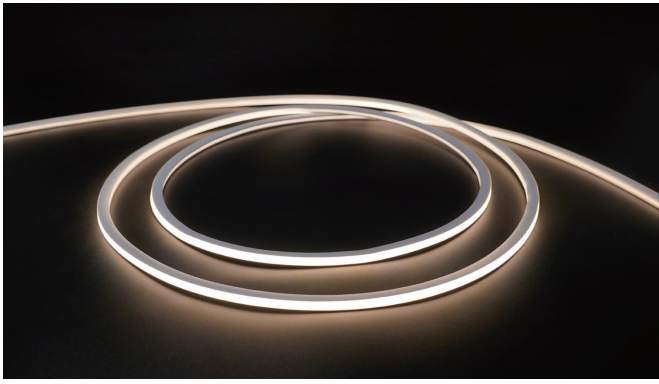

- Silicone co-extrusion process, with premium UV resistance, chemical stability and abrasion resistance.
- Vertical & horizontal bending in IP67 protection for indoor & outdoor use.
- Support freely configurable in length by small cutting increments for precise field installation.
- W8mm X H8mm small size LED neon with uniform light and dimmable function.
- Dust-free matt finish is optional.
- 5 years warranty, long-life LED > 50,000 hrs, 1 Bin.

### ORDERING GUIDE



PART #	INPUT (Vdc)	POWER (W / M)	POWER (W / Feet)	CRI	Max Run	Dimmable
FN0808DB	24V	6	1.8	90	7mt	Yes
FN0808DB	12V	6	1.8	90	7mt	Yes

### LUMENS PER METER

Color Temperature	Lumen per meter	Efficiency (LM/W)
1800±100	208	34.6
2100±150	233	38.9
2400±150	255	42.5
2700±150	279	46.5
3000±150	281	46.9
3500±200	285	47.5
4000 <sup>+400</sup> <sub>-200</sub>	281	46.8
5000 <sup>+500</sup> <sub>-300</sub>	275	45.8
6500±500	269	44.8
Red	31	5.2
Green	257	42.9
Blue	64	10.6
Yellow	58	9.6
Orange	68	11.4

### LUMINAIRE PHOTOMETRIC

#### LUMINOUS INTENSITY DISTRIBUTION DIAGRAM

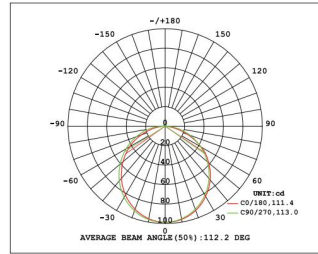

#### Illuminance curve

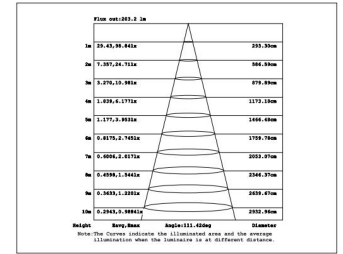

### CABLE ENTRY ( Unit: mm )

Integral end cap (IP67)

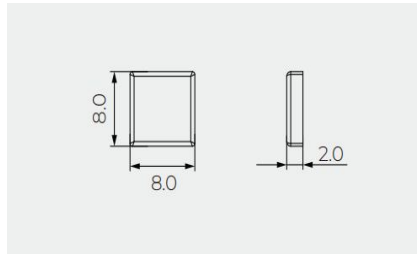
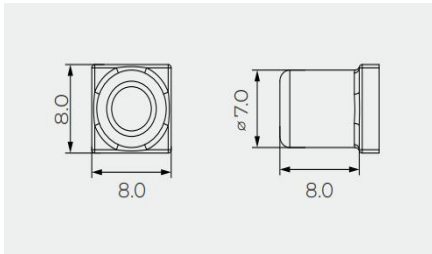

Front Cable Entry



Closed End cap

### CABLE

Cable Type	Schematic Diagram	Specification	Core	Electrical Properties
Silicone Cable		OD: 4.0mm / Inner core: 22AWG		Red V+, Black V-
Waterproof Connector with Silicone Cable		OD: 4.0mm / Inner core: 22AWG M12Male / Female connector		Red V+, Black V-

### CUTTING MARK



Remark:  
The bottom of the led strip has transparent window, the black marker is the cutting position.



Use professional scissors to cut vertically at the cutting mark

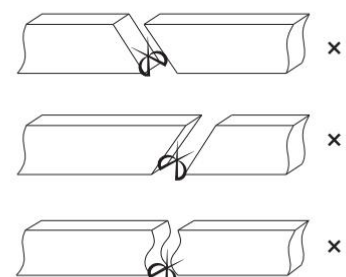

Use professional scissors to cut vertically at the cutting mark

### ACCESSORIES ( Unit: mm )

#### Transparent plastic groove

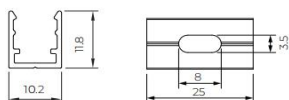

Dimension:  
25X10.2X11.8  
Accessories:  
Screw M3x16 (SUS304)

#### Aluminium Profile

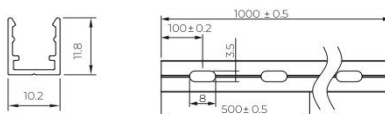

Dimension:  
1000X10.2X11.8  
Accessories:  
Screw M3x16 (SUS304)

#### Curved profile

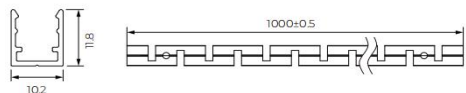

Dimension:  
1000X10.2X11.8  
Accessories:  
Screw M3x16 (SUS304)

### INSTALLATION PRECAUTIONS

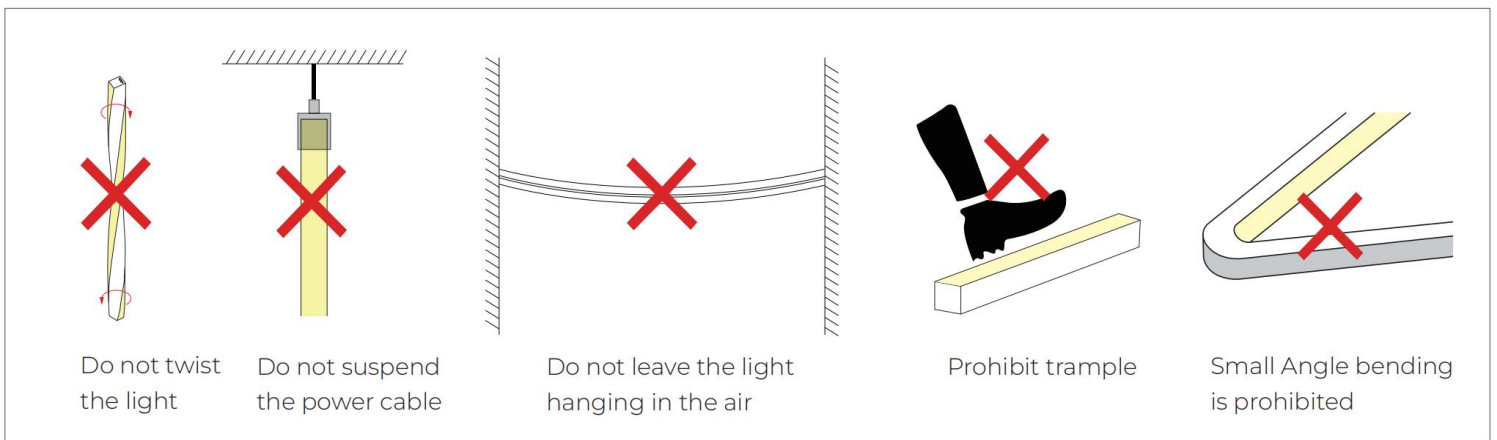
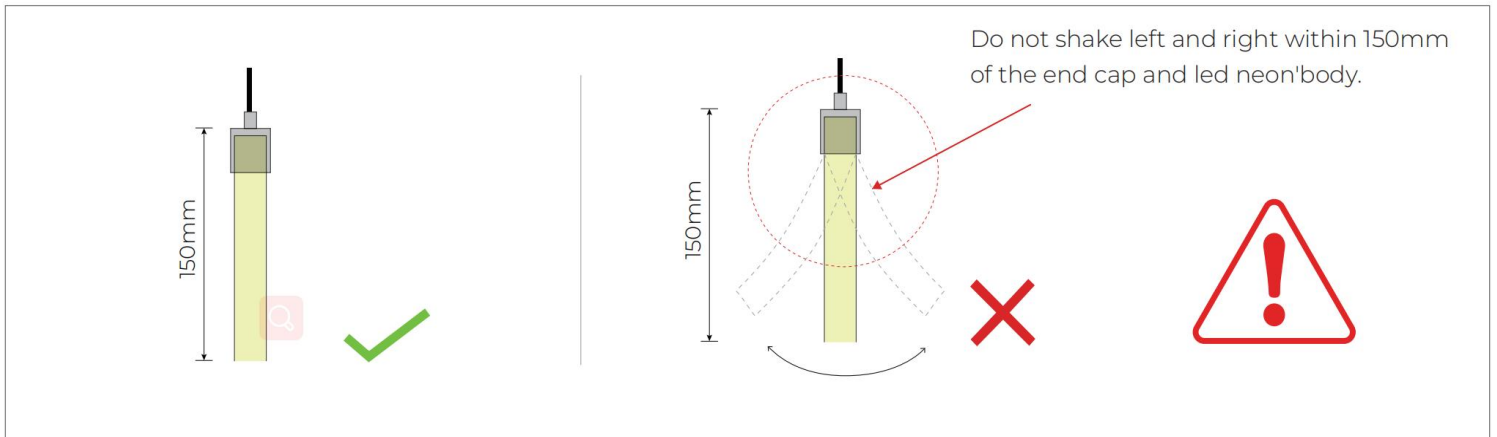

### Put it in the profile

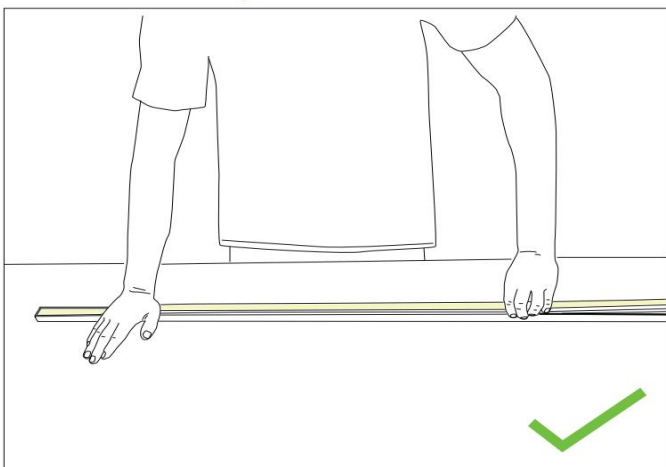

- Please press the led strip with your palm to slowly insert the led strip into the groove, and gently straighten the led strip above the groove with your right hand.
- Try to keep the led strip in a flat state during the installation process.

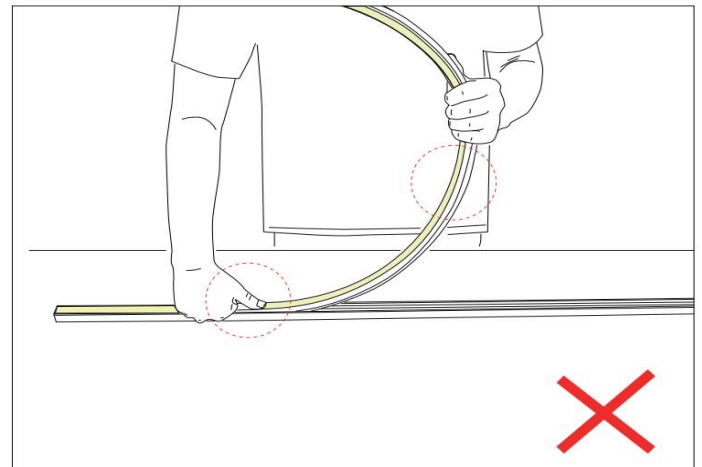

- Do not press the led strip with a single finger, it is easy to damage the internal parts of the led strip.
- The bent arc of the led strip should not be too large during installation.